



MELBOURNE
SKYDECK

EVENT
PACKAGES



INTRODUCING MELBOURNE SKYDECK

Located in the heart of the city, Melbourne Skydeck embodies the essence of Melbourne and its surrounding wonders. Boasting the title of the southern hemisphere's tallest observation deck, the Melbourne Skydeck offers an awe-inspiring experience that captivates, entertains, and educates visitors with its breathtaking and dynamic views. It immerses guests in a realm of suspended thrills, complemented by cutting-edge virtual and augmented realities, providing a truly mesmerizing adventure.

It's Melbourne on another level!

GROUP EXPERIENCE PACKAGES

Looking for a unique group or team outing? Gather your friends or colleagues and embark on an unforgettable adventure at Melbourne Skydeck, an unparalleled activity that can't be found anywhere else in Melbourne.

Whether you're celebrating a special occasion, impressing clients, or simply craving a unique get-together, our space is the perfect choice for creating lasting memories. Elevate your event to new heights, both literally and figuratively, and make a reservation today. Melbourne's skyline is waiting to be your backdrop for a one-of-a-kind gathering that will leave everyone in awe.

Situated 88 floors above the city, Melbourne Skydeck provides an unparalleled view, along with cutting-edge virtual reality experiences and delectable gourmet food and beverage options carefully crafted by Executive Head Chef Renee Martillano.

Each event package includes a dedicated group service host and a designated area where your group can relish quality time together.

EXPERIENCES

Virtual Reality Voyager Theatre

The first of its kind in the Southern Hemisphere and largest of its kind in the world, the award-winning Voyager Theatre VR takes you on an immersive virtual journey around 16 iconic Melbourne and Victoria experiences. From feeling the thrill of riding Luna Park's rollercoaster, to the thunderous crowd at the MCG you'll be amazed by the 360-degree cinematic and sensory voyage in 6D, Super 8K high-definition and scent sensations.

Edge

There's the view, then there's standing 88 floors above Southbank with nothing but a transparent glass floor beneath you. A world-first, Edge suspends thrill seekers in a transparent glass cube that projects three metres out from the Skydeck, leaving guests suspended nearly 300 metres above the streets. Challenge your group, face their fears and push their boundaries. This heart-pounding experience promises unforgettable memories.

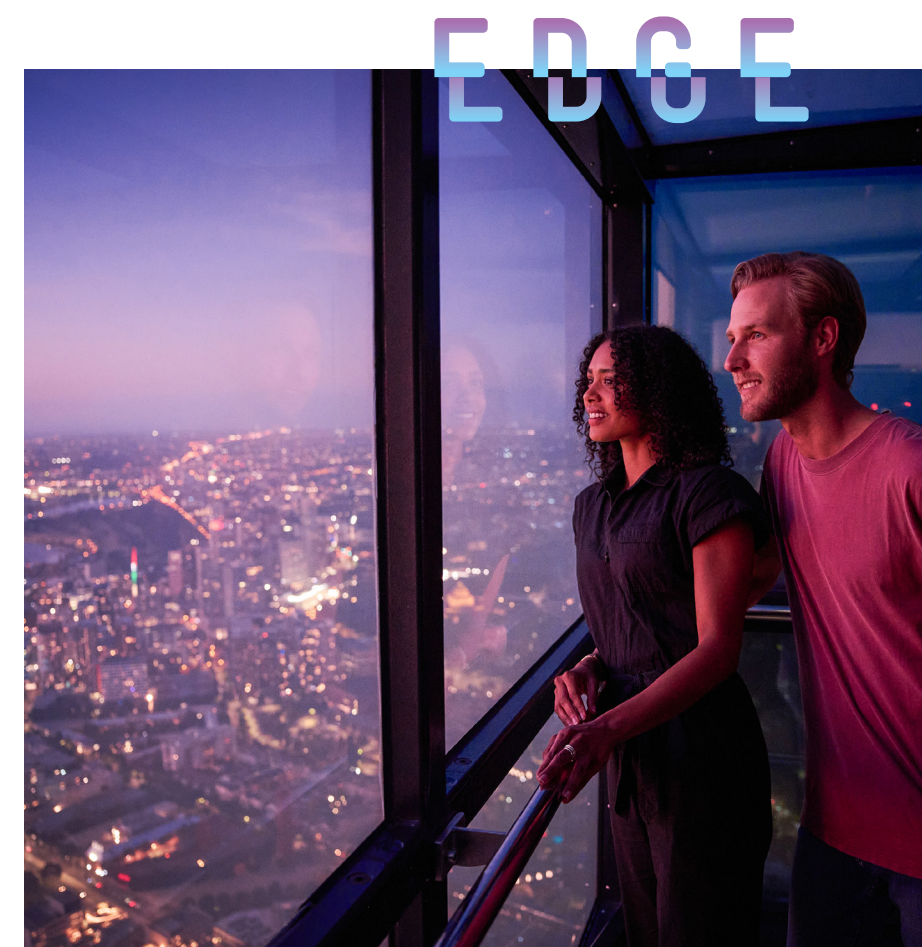

PACKAGES

EVENT SPACE

A unique event space situated 300m above Melbourne.

Our exclusive VIP area is located on the observation deck with breathtaking views of Melbourne. During the event, attendees will enjoy access to this private space and can choose to either remain there or explore the observation deck while taking in the stunning scenery.

EVENT PACKAGES

Create your customized event package, featuring our 1-hour drinks or bar tab package and a variety of additional options.

1 HOUR DRINKS PACKAGE - \$45PP*

The package includes access to the observation deck, exclusive VIP space, a dedicated host with a beverage package, including beer, wine, and soft drink.

OR

1 HOUR BAR TAB PACKAGE*

The package includes access to the observation deck, exclusive VIP space, and a dedicated host to serve your package, which includes beer, wine, and soft drink, with the option to include a variety of spirits, cocktails, and champagne upon request.

**Please note that minimum food and beverage spend requirements are applicable. 1 Hour Drinks Package or Bar Tab must be selected for Add Ons.*

ADD ONS

Set your event apart with exclusive add ons and memorable expediences.

FOOD AND DRINK

Canapès (selection of 3) *\$20pp*

Canapès (selection of 6) *\$40pp*

Charcuterie Platter (approx. 10 guests) *\$100 per platter*

Signature Bar 88 Signature Cocktail *\$18pp*

Additional 1 Hour Drinks Package *\$10pp*

French Champagne *\$30pp*

EXPERIENCES

Edge *\$15pp*

Voyager Theatre *\$15pp*



FOOD AND BEVERAGE

CANAPÈ OPTIONS

HOT CANAPÉS

Tomato, basil & bocconcini arancini, pesto aioli - *v, gf*

Fried prawn wonton, coriander, chilli dip

Spiced chicken skewer, ginger, lemongrass & coriander glaze - *gf*

Onion bhaji, coriander, green chilli yoghurt - *v*

Argentinian beef & chimichurri pie, tomato jam

Steamed shiitaki & vegetable dumpling, soy dip - *v*

Hot chip bowls, onion, parmesan - *v, gf*

COLD CANAPÉS

Roasted heirloom tomato & mozzarella tartlette, basil - *v, gf*

Roast duck, thai coconut pancake, coriander

Lamb backstrap, marinated beetroot, sunflower seed emulsion - *gf*

DESSERT CANAPÉS

Chocolate fudge, freeze dried raspberry - *gf*

BEVERAGE PACKAGE

BEER, WINE AND SOFT DRINK* *Selection of Beers, local and Australian Wines*

** Food and Beverage selection subject to availability and may change at any time.*



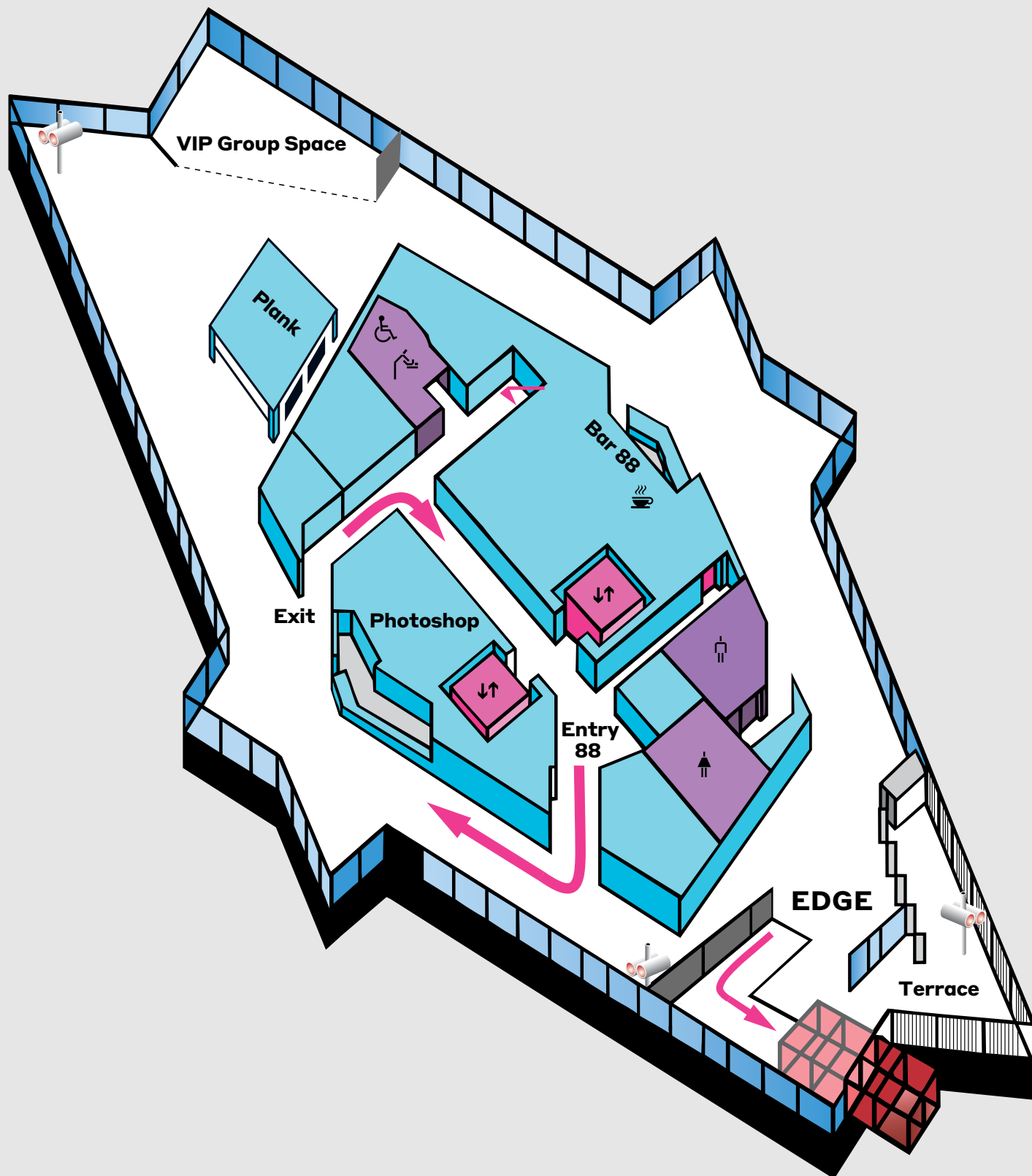

TERMS AND CONDITIONS

CONFIRMATION & DEPOSIT

Confirmation of a booking by the client must be made within seven days of a tentative reservation being confirmed, by returning the signed confirmation agreeing to these terms and conditions and paying a 50% deposit. If the confirmation is not received within seven days, the venue reserves the right to cancel a booking and allocate the space to another client.

FINAL PAYMENT

Full payment must be made 7 days prior to the date of the event, either by electronic funds transfer or credit card. Melbourne Skydeck accepts Visa and MasterCard. If payment is not made by the event date, or an arrangement for payment after the event is not agreed upon by the venue and client, the venue reserves the right to not host the client event.

CANCELLATION

In the case of an event cancelling the following terms and conditions are applicable:

- For 15 days or greater notice, the deposit will be refunded in full.
- If 14 days or less notice, the cancellation fee will be 50% of the total revenue anticipated at the time of booking.
- A change or postponement of an event within the timings above will be considered a cancellation and the above charges will apply.

FINAL ATTENDANCE

Final number of confirmed guests is required seven working days prior to your event. If final numbers are not confirmed, an invoice will be issued for the estimated number of guests anticipated at the time of booking, whether full attendance is received. It is the responsibility of the client to contact the venue regarding final numbers.

PRICES

All prices are current at the time of the quotation and are subject to revision prior to the signing of the confirmation agreement. Prices are inclusive of any goods and services or similar added tax. Please note menus and pricing are subject to change without notice. Although every endeavour is made to obtain your selected food and beverages, due to supplier stock availabilities no guarantee is provided that your selection will be available in the required quantity. A comparable item will be offered in this instance.

FOOD ALLERGIES

The venue will take every reasonable action to ensure guests with dietary allergies are catered for appropriately but cannot be held responsible should exposure to a particular allergen occur.

DESIGNATED TIMES AND DURATIONS

The client agrees to begin the event and vacate the designated event space at the contracted times. The event duration can only be extended by the client, or your nominated representatives, in consultation with the management subject to an agreement to incur this additional cost. Beverages and associated additional costs will be charged on a pro rata package increase, based on full guest numbers confirmed for the event, and will be payable on the completion of the event.

DISPLAYS & SIGNAGE

Unless approved by venue management prior to the event, no signs, displays, labels or decorations are to be nailed, screwed, taped, stapled or adhered to any surface or part of the venue.

DAMAGE & CLEANING

Clients are financially responsible for any damage sustained to the venue and its contents and property prior to, during and after the event by the client, guests or suppliers engaged by the client. If cleaning is required beyond the normal required function contractors, this extra fee is the responsibility of the client. Confetti, glitter, poppers, streamers or rice are not permitted. It is the responsibility of the client to ensure their guests are notified of this.

RESPONSIBILITY

The venue management will take necessary care but does not accept responsibility for the damage or loss of client, supplier or guest items left on the premises prior to, during, or after the event. The onus to arrange insurance is that of the client.

RESPONSIBLE SERVICE OF ALCOHOL

Melbourne Skydeck management and staff adhere to strict State of Victoria Responsible Service of Alcohol regulations and all clients and guests are required to adhere to these regulations. Venue management reserves the right to exclude or eject any objectionable persons from the premises. In addition, the management reserves the right to stop entertainment, gaming or other activity, which in their opinion is illegal, improper, indecent or unsafe and is a likely nuisance.

BUILDING RULES

The venue is a member of the Eureka Tower Body Corporate and is required to comply with all rules in relation to the Eureka Tower building. The Body Corporate are also responsible for the operation of the building services including the lifts. All clients agree to comply with all the building rules including all fire and safety procedures and possible evacuations and acknowledge that venue management are not responsible for any interruption or inconvenience which may occur due to the building rules or building services under the Body Corporate's control.



@melbourneskydeck



@melbourneskydeck

Melbourne Skydeck

(03) 9693 8888 | events@melbourneskydeck.com.au | melbourneskydeck.com.au

Melbourne Skydeck All information & prices are correct at time of Publication (Jun 2023) and subject to change without notice.

MELBOURNESKYDECK.COM.AU

JOURNEY BEYOND